

# Domekt R 300 V C6

Maximal air flow, m <sup>3</sup> /h	320
Maximal air flow, l/s	89
Unit weight, kg	28
Supply voltage, V	1~230
Maximal operating current, A	HE 4
Thermal efficiency of heat recovery, %	85
Reference flow rate, m <sup>3</sup> /s	0,062
Reference pressure difference, Pa	50
SPI, W/(m <sup>3</sup> /h)	0,28
Filters dimensions B×H×L, mm	290×205×46
Electric power input of the fan drive at reference flow rate, W	30
Electric power input of the fan drive at maximum flow rate, W	72
Electric air heater capacity, kW / Δt, °C	0,5/ 6,2
Maintenance space, mm	450
Control system	C6

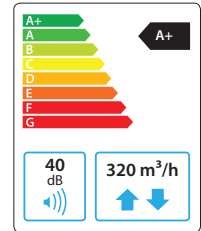

## Acoustic data

A-weighted sound power level  $L_{WA}$ , dB(A) at reference flow rate

Supply inlet	52
Supply outlet	60
Exhaust inlet	52
Exhaust outlet	60
Casing	40

A-weighted sound pressure level  $L_{pA}$ , dB(A)

10 m<sup>2</sup> normally isolated room, distance from casing – 3 m.

Surroundings	30
--------------	----

## Temperature efficiency

Outside temperature, °C	Winter					Summer		
	-23	-15	-10	-5	0	25	30	35
After heat exchanger, °C	15,3	16,5	17,2	18,0	18,7	22,5	23,2	24,0

indoor +22°C, 20 % RH

Shown as left (L1)

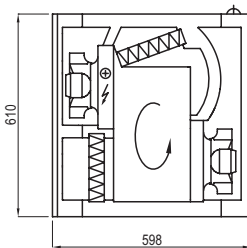

Shown as right (R1)

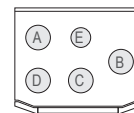

- A outdoor intake
- B supply air
- C extract indoor
- D exhaust air
- E additional extraction connection (by-pass – extraction without heat recovery)

## Performance

Unit with standard equipment

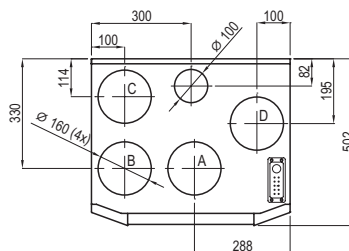
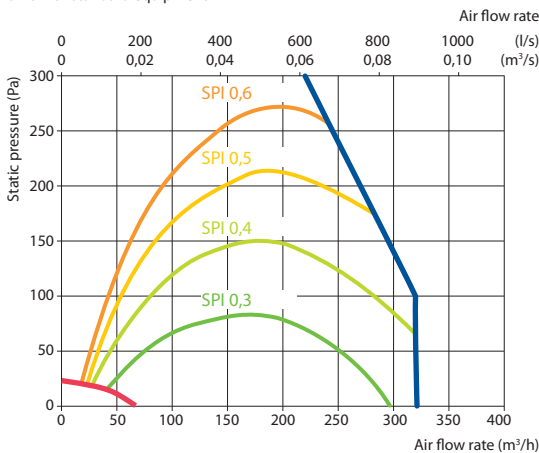

## Accessories

Closing damper	AGUJ-M-160+LF230/CM230
Silencer	A/D AGS-160-50-600-M
	B/C AGS-160-50-900-M
Water heater	DH-160
PPU	PPU-HW-3R-15-0,4-W2
2-way valve (heater)	VVP47.10-0,4

Water cooler	DCW-0,4-3
2-way valve (cooler)	VVP47.10-1,6
Outdoor grill	LD-160
Water heater-cooler	DHCW-160
DX cooler	DCF-0,4-3
Cooling unit	MOU-12HFN8-KA8140

C6.1



C6.2

